

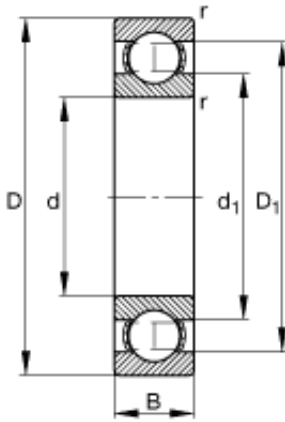

25 mm x 52 mm x 15 mm fag 6205 bearing



Bearing No. 6205

6205 Bearing 2D drawings and 3D CAD models

Size	25x52x15 mm
Bore Diameter	25 mm
Outer Diameter	52 mm
Width	15 mm
d	25 mm
D	52 mm
B	15 mm
D <sub>1</sub>	43,6 mm
D <sub>a max</sub>	46,4 mm
d <sub>1</sub>	33,5 mm
d <sub>a min</sub>	30,6 mm
r <sub>a max</sub>	1 mm
r <sub>min</sub>	1 mm
m	0,129 kg / Weight
C <sub>r</sub>	14900 N / Dynamic load rating (radial)
C <sub>0r</sub>	7800 N / Static load rating (radial)
n <sub>G</sub>	19600 1/min / Limiting speed
n <sub>B</sub>	14400 1/min / Reference speed
C <sub>ur</sub>	395 N / Fatigue limit load, radial